

CODIGO **28623**

DESCRIPCION: **CARRO RECOGECORCHERAS**

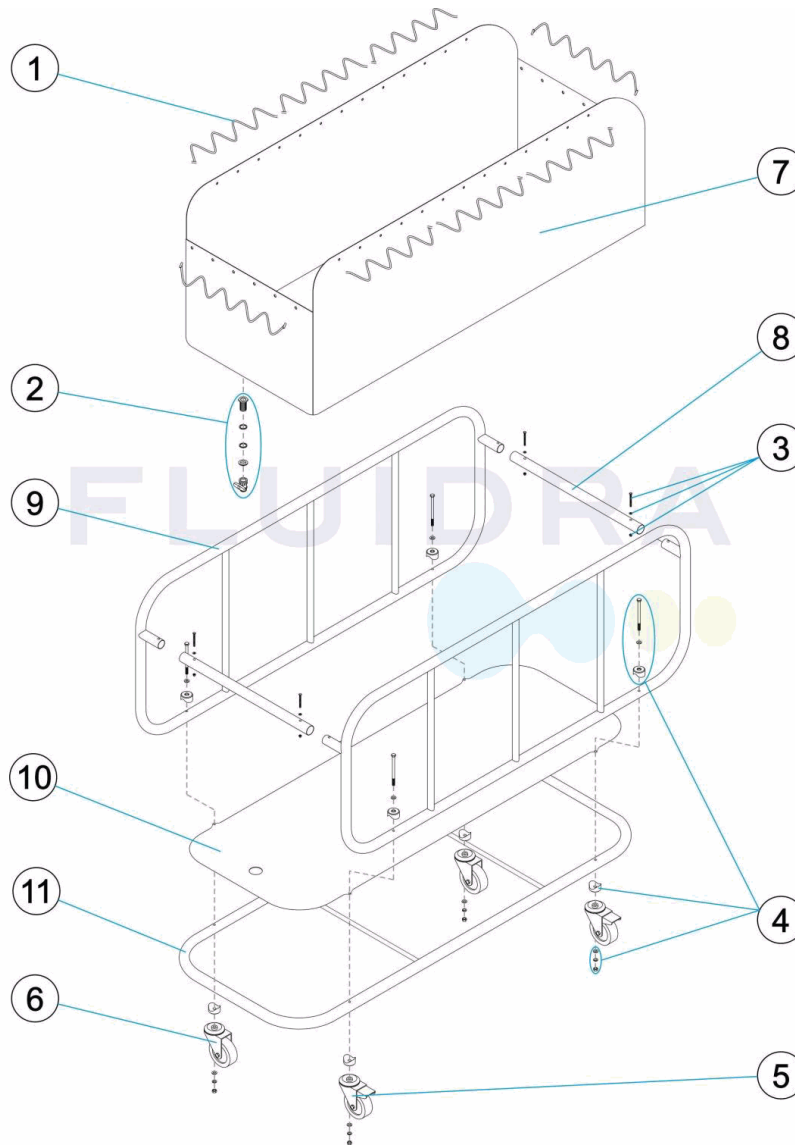

**ESPAÑOL**

POS	CODIGO	DESCRIPCION	POS	CODIGO	DESCRIPCION
1	4401050203	GOMAS DE ARASTRE	7	28623R0004	SACO RECOGECORCHERAS
2	4401080302	CJTO. DESAGUE	8	28623R0200	TRAVESAÑO UNION LATERALES
3	4401080005	TORNILLERIA FIJACION TUBO	9	28623R0100	ESTRUCTURA LATERAL SACO RECOG.
4	4401080301	TORNILLOS FIJACION RUEDA	10	28623R0301	SOPORTE INFERIOR
5	4401050407	RUEDA GOMA CON FRENO	11	28623R0300	ESTRUCTURA INFERIOR SACO RECOG.
6	4401050406	RUEDA GOMA SIN FRENO			

CODE **28623**

DESCRIPTION: **CHARIOT RAMASSE-LIGNES**

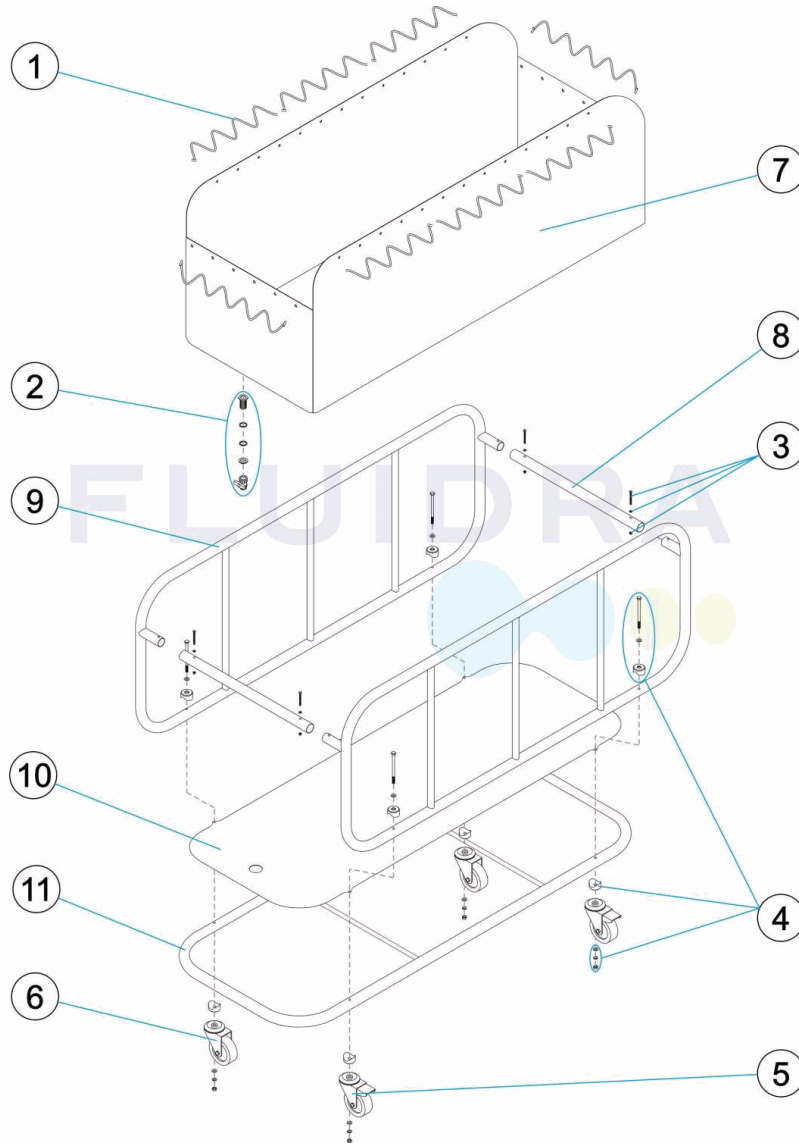

**FRANCAIS**

POS	CODE	DESCRIPTION	POS	CODE	DESCRIPTION
1	4401050203	SANGLES DE TRACTION	7	28623R0004	SAC RECUPERATION FLOTTEURS
2	4401080302	ENSEMBLE VIDANGE	8	28623R0200	TRaverse UNION LATERALE
3	4401080005	VISSERIE FIXATION TUBE	9	28623R0100	STRUCTURE LATERALE SAC
4	4401080301	VIS FIXATION ROUE	10	28623R0301	SUPPORT INFERIEURE
5	4401050407	ROUE CAOUTCHOUC AVEC FREIN	11	28623R0300	STRUCTURE INFERIEURE SAC
6	4401050406	ROUE CAOUTCHOUC SANS FREIN			

CODE **28623**

DESCRIPTION: **FLOAT LINE ROLLER**

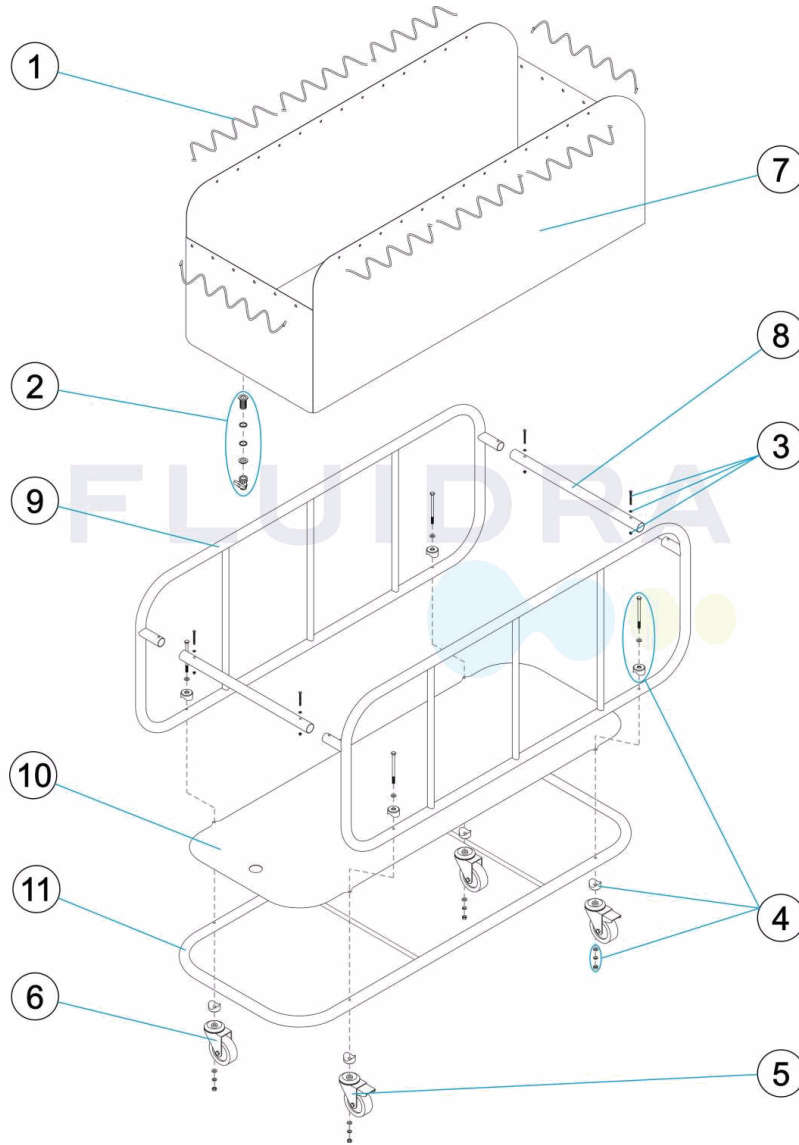

**ENGLISH**

POS	CODE	DESCRIPTION	POS	CODE	DESCRIPTION
1	4401050203	PULL RUBBERS	7	28623R0004	BAG FOR FLOAT LINES
2	4401080302	DRAINAGE SET	8	28623R0200	LATERAL CONNECTION PIPES
3	4401080005	SCREWS FOR FIXING TUBE	9	28623R0100	LATERAL STRUCTURE FLOAT LINES
4	4401080301	FIXING SCREWS FOR WHEELS	10	28623R0301	INFERIOR SUPPORT
5	4401050407	RUBBER WHEEL (WITH BRAKE)	11	28623R0300	INFERIOR STRUCTUR FOR FLOAT LINES
6	4401050406	RUBBER WHEEL (WITHOUT BRAKE)			

CODICE **28623**

DESCRIZIONE: **CARRO RACCOGLI-GALLEGGIANTI**

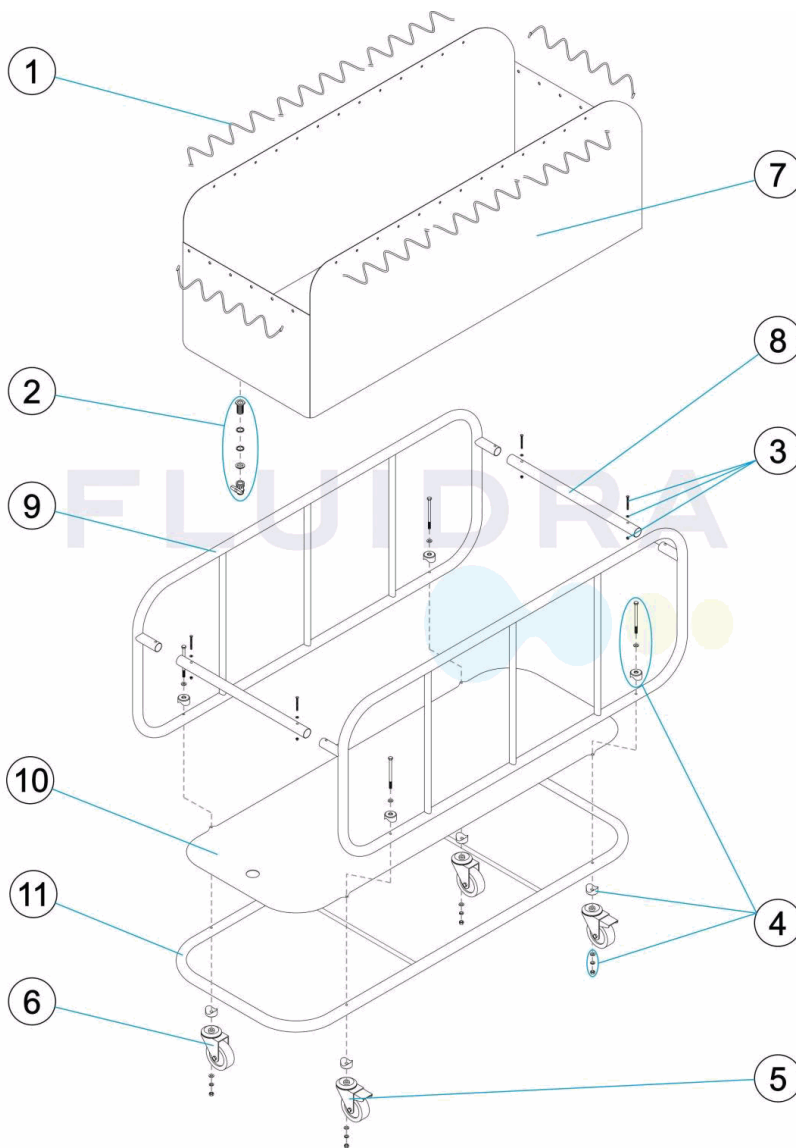

**ITALIANO**

POS	CODICE	DESCRIZIONE	POS	CODICE	DESCRIZIONE
1	4401050203	GOMME DI TRASCINAMENTO	7	28623R0004	SACCO RACCOGLICORSIA
2	4401080302	KIT SCARICO	8	28623R0200	TRAVERSA UNIONE LATERALE
3	4401080005	ELEMENTI DI FISSAGGIO DEL TUBO	9	28623R0100	STRUTTURA LATERALE SACCO RACCOGLICORSI/
4	4401080301	VITI FISSAGGIO RUOTA	10	28623R0301	SUPPORTO INFERIORE
5	4401050407	RUOTA GOMMA CON FRENO	11	28623R0300	STRUTTURA INFERIORE SACCO RACCOGLICORSI
6	4401050406	RUOTA GOMMA SENZA FRENO			

CODE **28623**

BESCHREIBUNG: **KARREN LEINENSCHWIMMER**

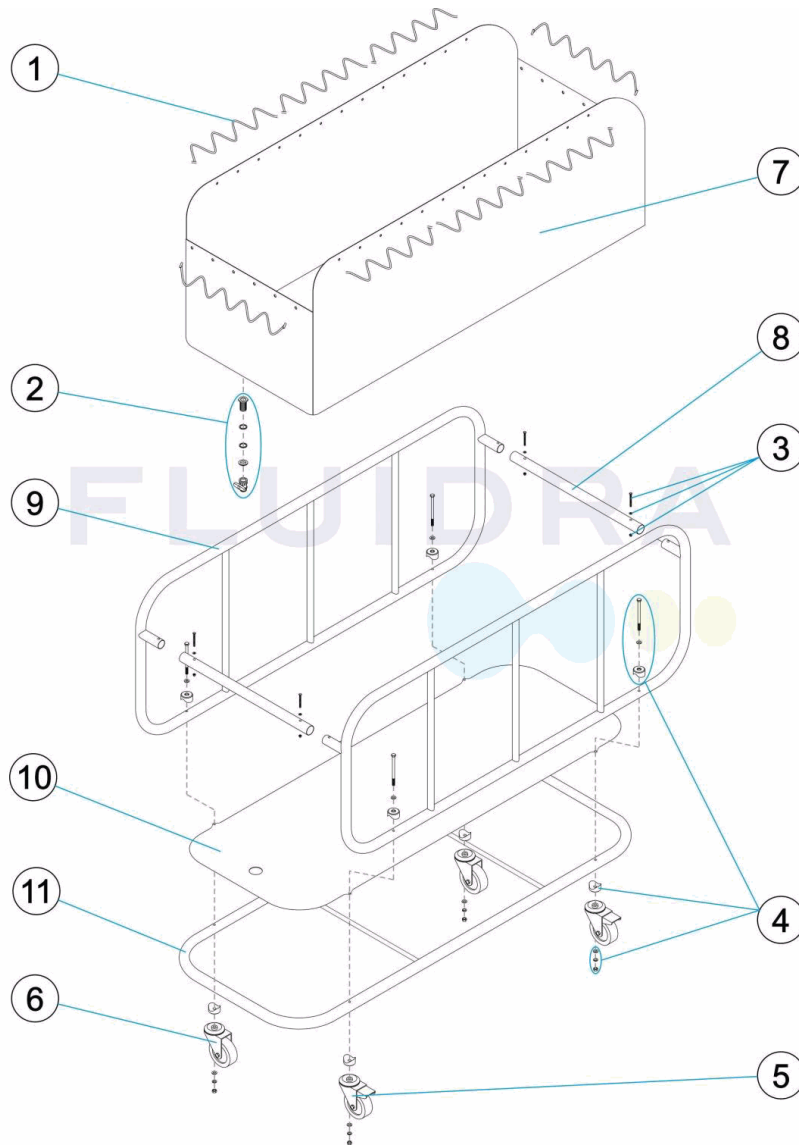

**DEUTSCH**

POS	CODE	BESCHREIBUNG	POS	CODE	BESCHREIBUNG
1	4401050203	ZUGGUMMIS	7	28623R0004	BEUTEL LEINENSCHWIMMER
2	4401080302	SET ABFLUSS	8	28623R0200	QUERTEIL VERBINDUNG SEITLICH
3	4401080005	FIXIERSCHRAUBEN ROHR	9	28623R0100	SEITENSTRUKTUR BEUTEL
4	4401080301	FIXIERSCHRAUBEN RAD	10	28623R0301	HALTERUNTEN
5	4401050407	GIMMIRAD MIT BREMSE	11	28623R0300	STRUKTUR UNTEN BEUTEL
6	4401050406	GIMMIRAD OHNE BREMSE			

CODIGO **28623**

DESCRIÇÃO: **CARRO RECOLHA FLUTUADORES**

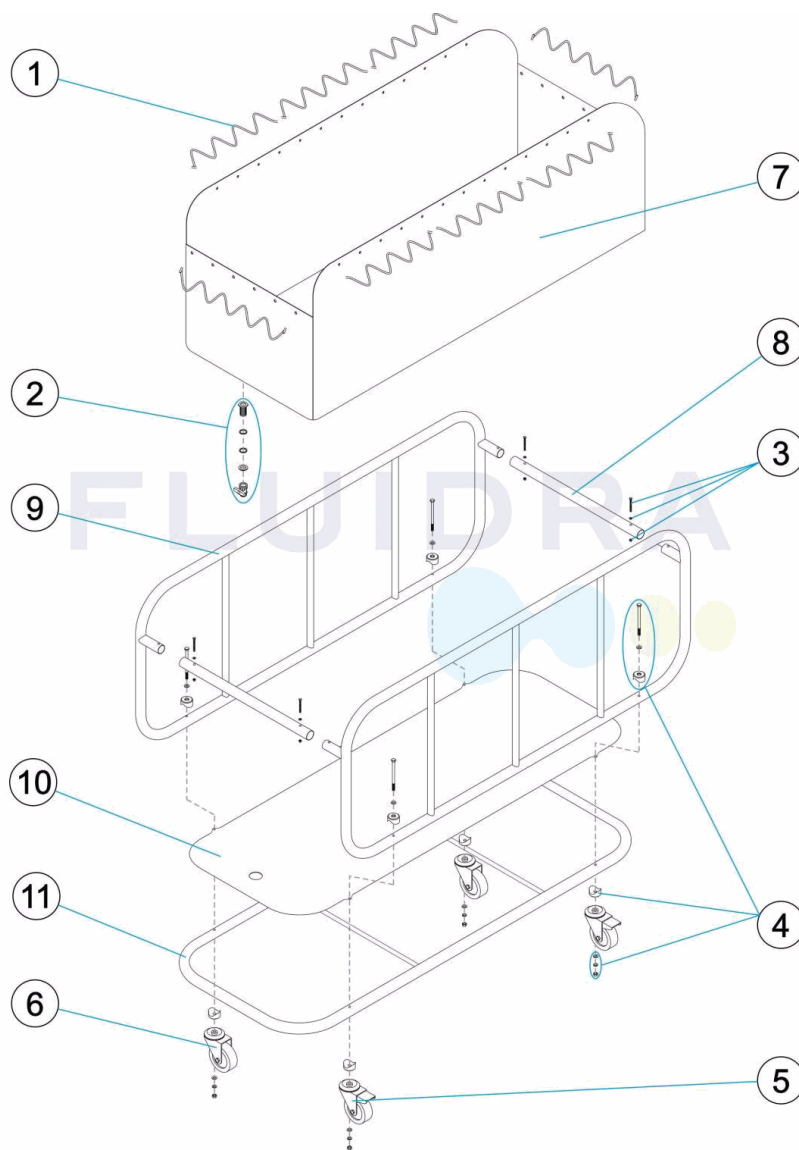

**PORTUGUES**

POS	CODIGO	DESCRIÇÃO	POS	CODIGO	DESCRIÇÃO
1	4401050203	BORRACHAS DE ARRASTO	7	28623R0004	SACO RECOLHE PISTAS DE NATAÇÃO
2	4401080302	CJTO. ESGOTO	8	28623R0200	TRAVESSA UNIÃO DAS LATERAIS
3	4401080005	PORCAS E PARAFUSOS FIXAÇÃO TUBO	9	28623R0100	ESTRUTURA LATERAL SACO RECOLHE
4	4401080301	PARAFUSOS PARA FIXAÇÃO DE RODA	10	28623R0301	SUPORTE INFERIOR
5	4401050407	RODA BORRACHA COM TRAVÃO	11	28623R0300	ESTRUTURA INFERIOR SACO RECOLHE
6	4401050406	RODA BORRACHA SEM TRAVÃO			