

CODE **00301**

BESCHREIBUNG: **"ANSAUGDÜSE SCHWIMMBECKEN BETON GEWINDE 2""**

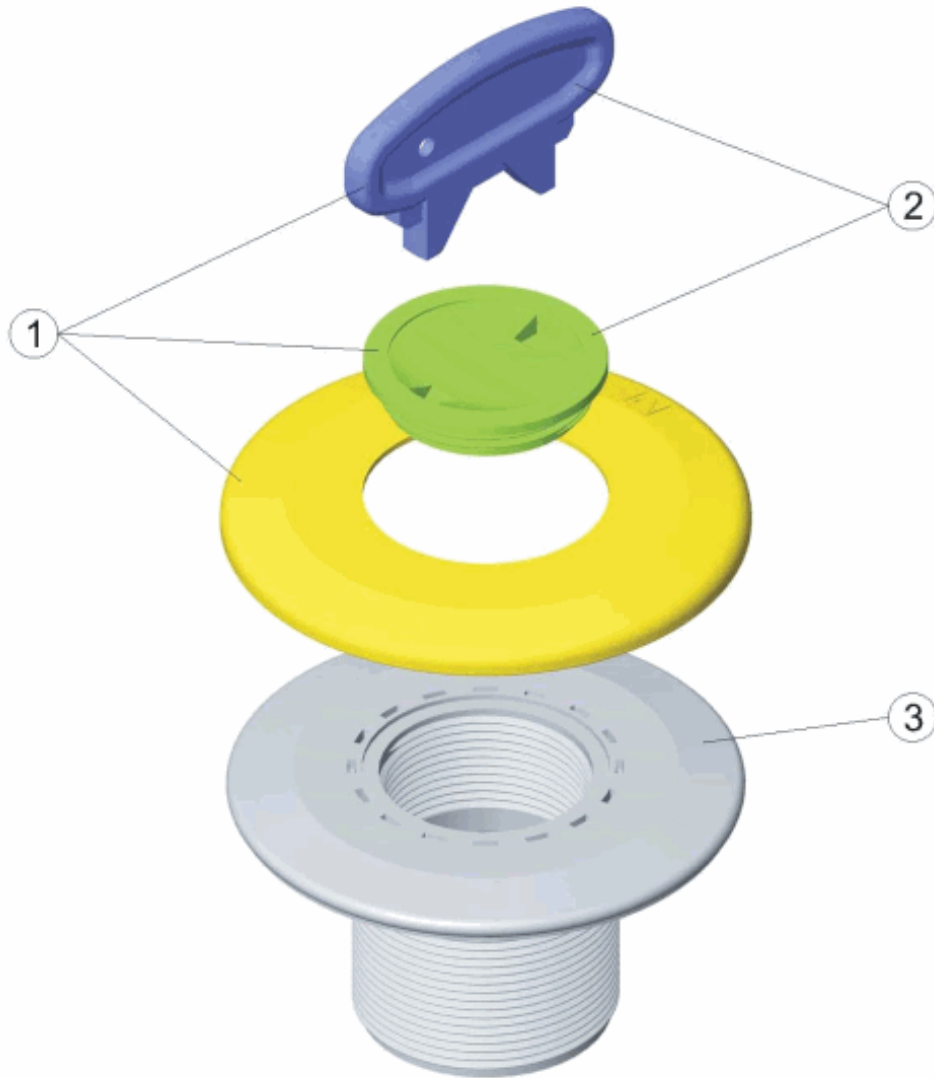

**DEUTCHE**

POS	CODE	BESCHREIBUNG	POS	CODE	BESCHREIBUNG
1	4402040501	VERSCHLUSSSTOPFEN ABS SAUGANSCHLUSS	3	00294R0001	GRUNDELEMENT DÜSE 2"
2	4402043101	VERSCHLUSSKAPPE SAUGANSCHLUSS			

CODE **00301**

DESCRIPTION: **"SCREW-IN SUCTION NOZZLE CONCRETE POOL 2"""**

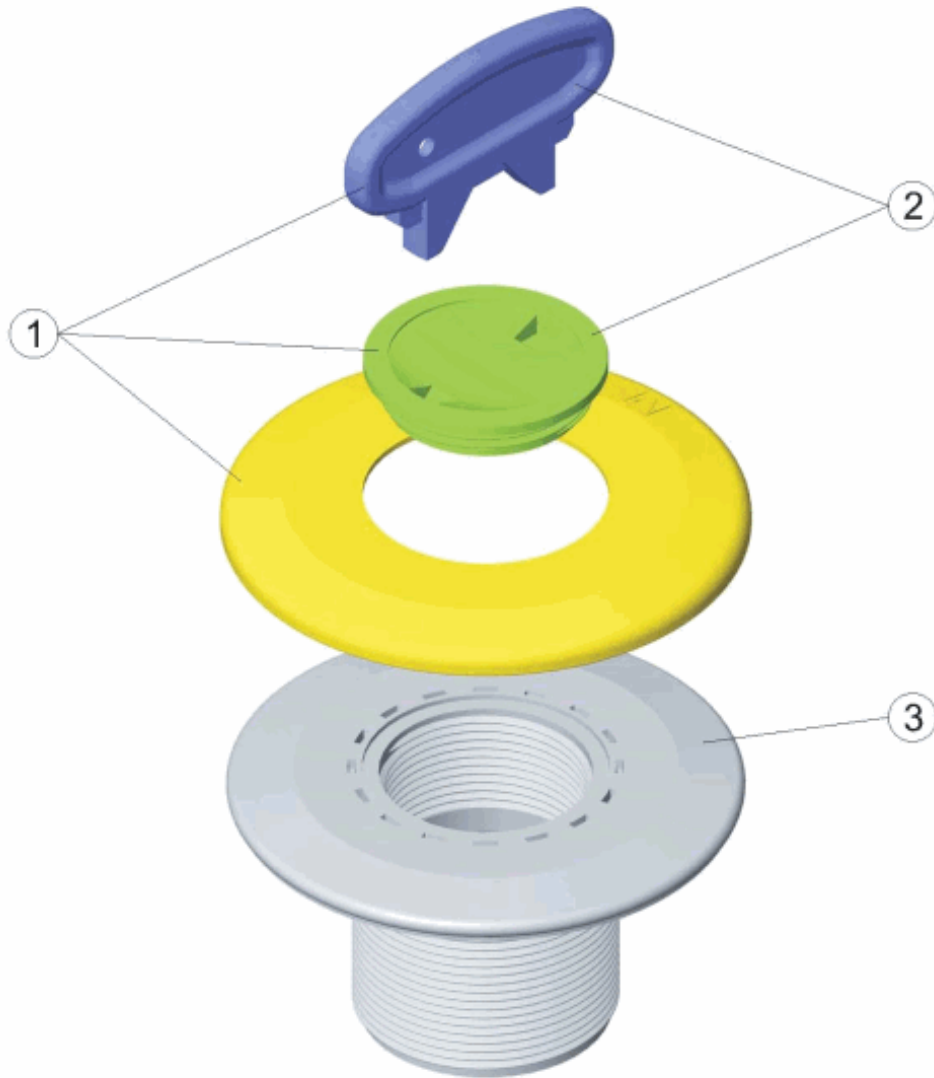

**ENGLISH**

POS	CODE	DESCRIPTION	POS	CODE	DESCRIPTION
1	4402040501	INLET COVER PLATE + CAP	3	00294R0001	INLET BASE 2"
2	4402043101	INLET CAP			

CODIGO **00301**

DESCRIPCION: **BOQUILLA ASPIRACION PISCINA HORMIGON ROSCA 2"**

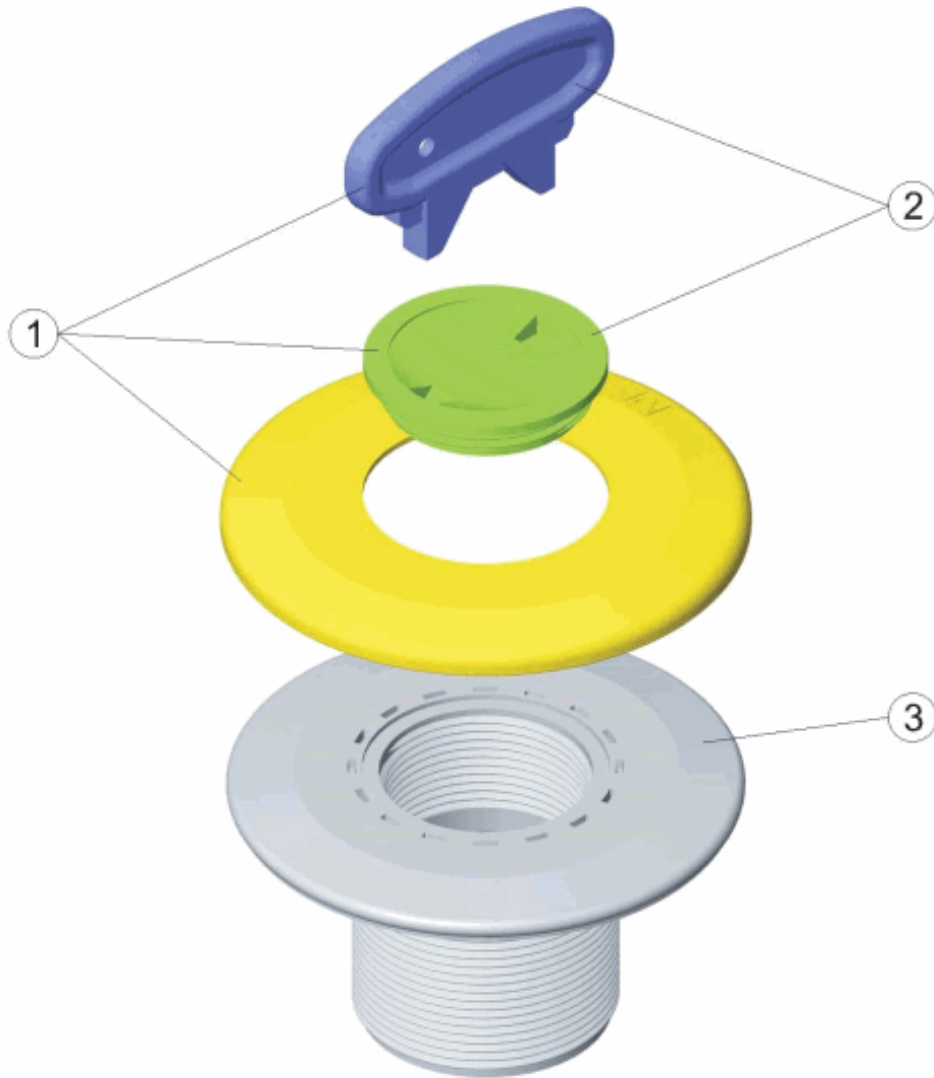

**ESPAÑOL**

POS	CODIGO	DESCRIPCION	POS	CODIGO	DESCRIPCION
1	4402040501	TAPON Y TAPETA BOQUILLA	3	00294R0001	BASE BOQUILLA ROSCADA 2"
2	4402043101	TAPON BOQUILLA			

CODE **00301**

DESCRIPTION: **"BOUCHE ASPIRATION PISCINE BÉTON VIS 2"''''**

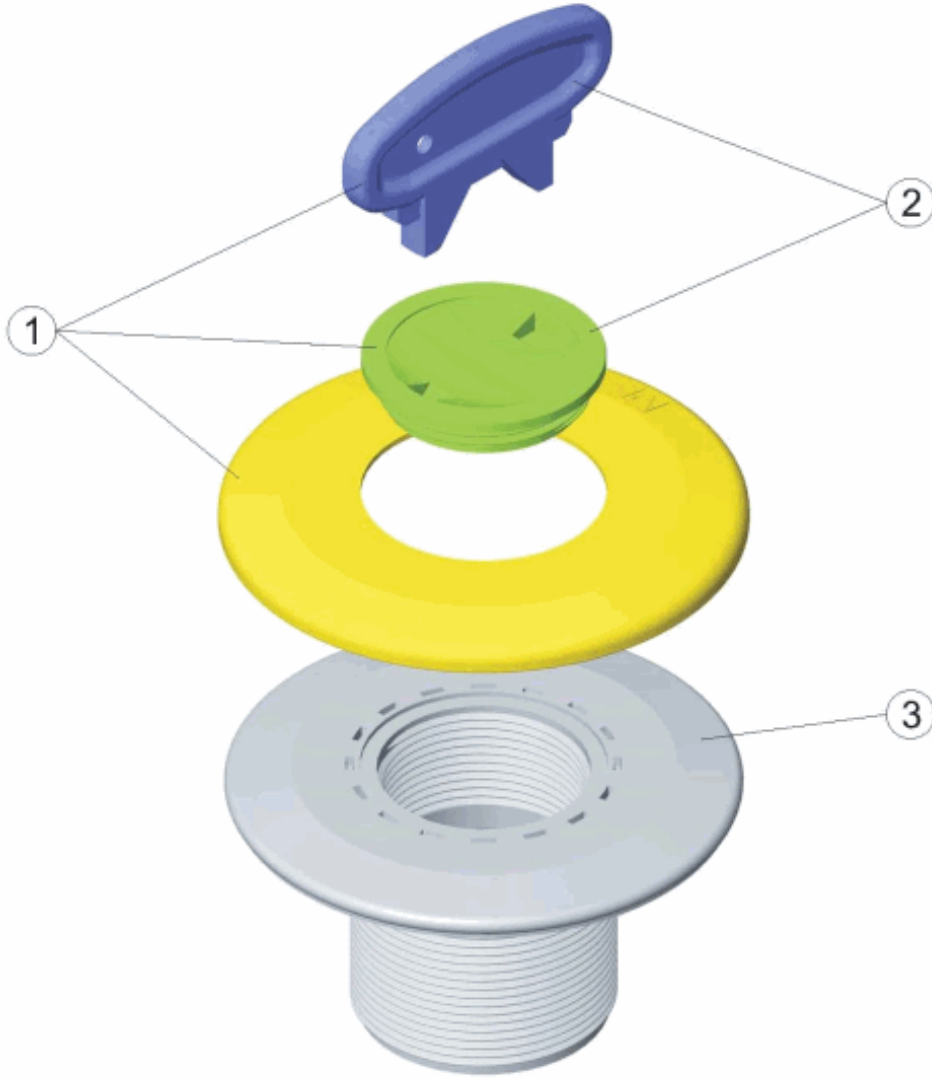

**FRANCAIS**

POS	CODE	DESCRIPTION	POS	CODE	DESCRIPTION
1	4402040501	BOUCHON ET COLLERETTE	3	00294R0001	CORPS DE BOUCHE DE REFOULEMENT 2"
2	4402043101	BOUCHON DE BOUCHE			

CODICE **00301**

DESCRIZIONE: **"BOCCHETTA ASPIRAZIONE PISCINA CEMENTO FILETTO 2"\*\*\*\*"**

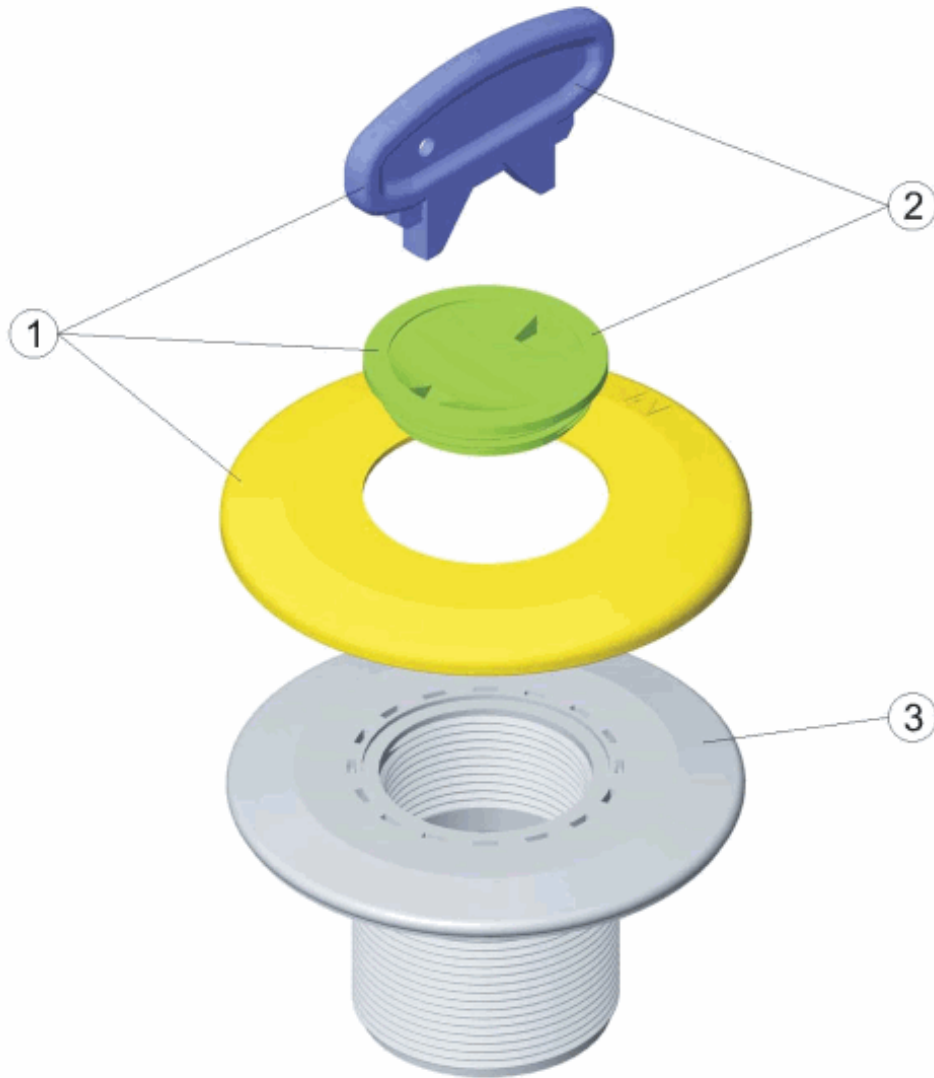

**ITALIANO**

POS	CODICE	DESCRIZIONE	POS	CODICE	DESCRIZIONE
1	4402040501	TAPPO E COPERCHIETTO BOCCHETTA	3	00294R0001	BASE BOCCHETTA 2"
2	4402043101	COPERCHIO BOCCHETTA			

CODIGO **00301**

DESCRIÇÃO: **"BOQUILHA ASPIRAÇÃO PISCINA BETÃO ROSCA 2"\*\*\*\*\*"**

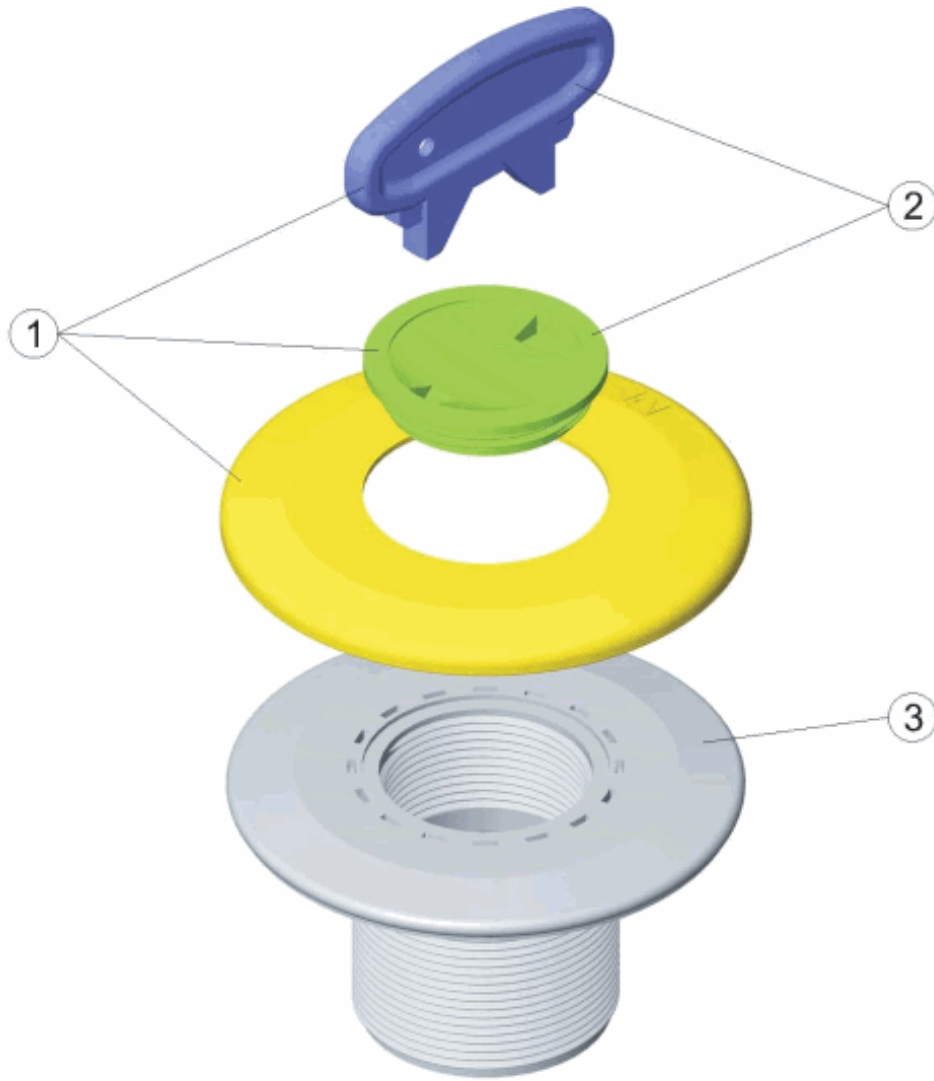

**PORTUGUES**

POS	CODIGO	DESCRIÇÃO	POS	CODIGO	DESCRIÇÃO
1	4402040501	TAMPÃO DE BOCA	3	00294R0001	BASE BOCA 2"
2	4402043101	TAMPÃO BOCA			